

深圳市金点液晶显示电子有限公司

SHENZHENSHI KIND LIQUID CRYSTAL DISPLAYER ELECTRONICS CO. , LTD

TEL: 15889732276

APPROVAL SHEET

承认书

记录编号:

版本: v0.0

Customer 客户名称	
Part NO. 产品型号	KD240IT002
Product type 产品内容	Mode: Transmissive type .Normally white. TFT LCD Module LCD Module: Graphic 240RGB*320Dot-matrix
Remarks 备注栏	<input type="checkbox"/> APPROVAL FOR SEPCIFICATIONS ONLY <input checked="" type="checkbox"/> APPROVAL FOR SEPCIFICATIONS AND SAMPLE
Signature by Customer: 客户确认签章	

金点确认

核准	审核	定制

客户确认

核准	审核	审核

深圳市金点液晶显示电子有限公司

SHENZHENSHI KIND LIQUID CRYSTAL DISPLAYER ELECTRONICS CO. , LTD

TEL: 15889732276

TABLE OF Contents

1. General Description.....	3
2. Features.....	3
3. Mechanical Specification.....	3
4. Mechanical Dimension.....	3
5. Maximum Ratings.....	5
6. Electrical Characteristics.....	5
7. Backlight Characteristic.....	5
8. Module Function Description.....	6
9. Revision History	7

深圳市金点液晶显示电子有限公司

SHENZHENSHI KIND LIQUID CRYSTAL DISPLAYER ELECTRONICS CO. , LTD

TEL: 15889732276

1. General Description

KD240IT002 is a 240RGB*320 dots matrix TFT LCD module. It has a TFT panel composed of 720 sources and 320gates. The LCM can be easily accessed by micro-controller.

2. Features

Display Mode	Transmissive
	a-TFT
Display Format	Graphic 240RGB*320 Dot-matrix
Input Data	8/16 bits parallel interface by 8080 MPU
Viewing Direction	12 o'clock
Drive	ILI9341

3. Mechanical Specification

Item	Specifications	Unit
Dimensional outline	42.72(W)*60.26(H)*3.4MAX(T) (FPC not include)	mm
Resolution	240RGB*320	dots
LCD Active area	36.72(W)*48.96(H)	mm
Pixel size	0.153(W)*0.153(H)	mm

4. Mechanical Dimension

深圳市金点液晶显示电子有限公司

SHENZHENSHI KIND LIQUID CRYSTAL DISPLAYER ELECTRONICS CO., LTD

TEL: 15889732276

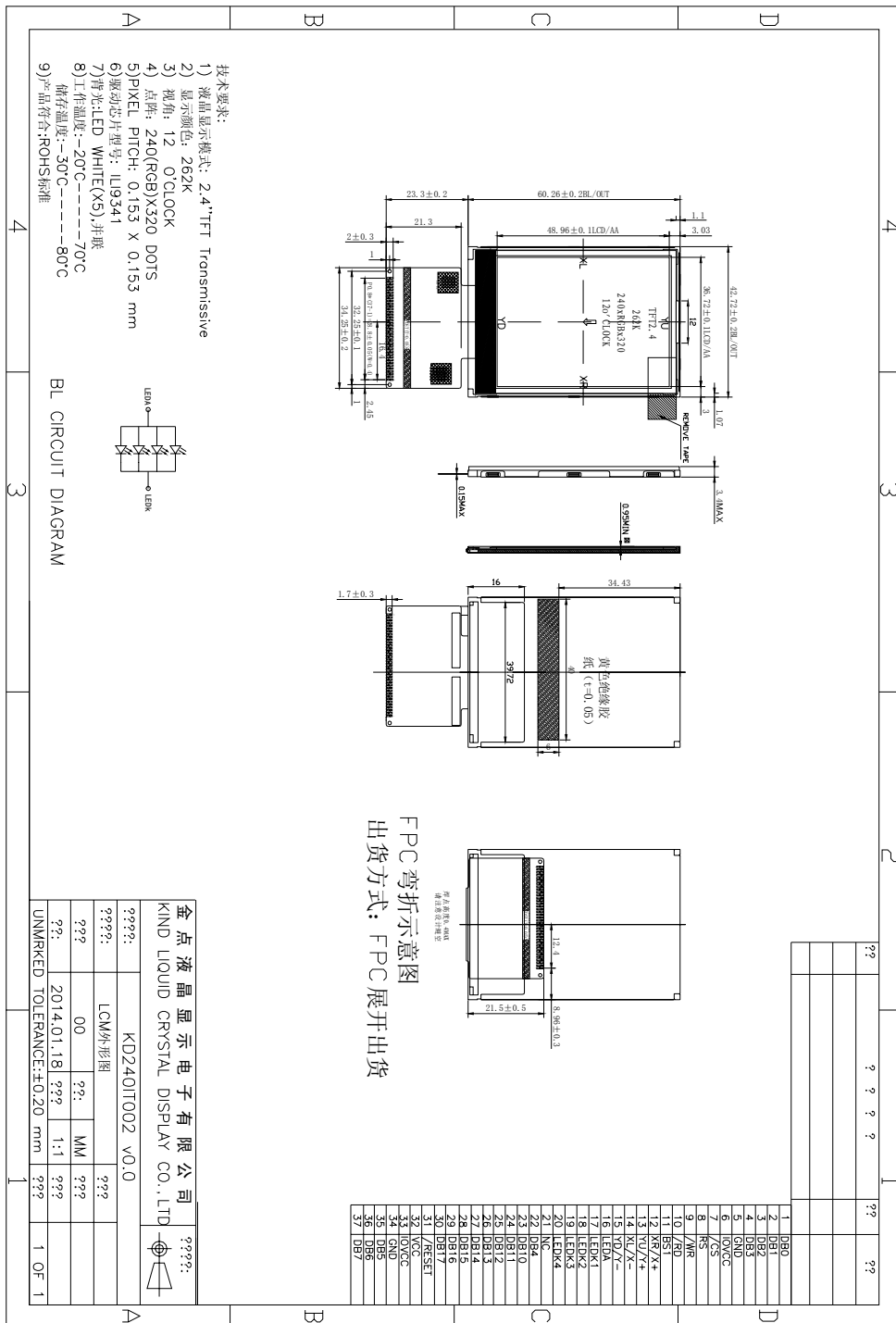

深圳市金点液晶显示电子有限公司

SHENZHENSHI KIND LIQUID CRYSTAL DISPLAYER ELECTRONICS CO., LTD

TEL: 15889732276

5. Maximum Ratings

Item	Symbol	Min	Max	Unit	Note
Supply voltage	V	-0.3	4.6	V	
Operating temperature	V _T	-0.3	V _{CC} +0.3	V	
Storage temperature	T _{OPR}	-20	70	°C	
Storage temperature	T _{STR}	-30	80	°C	

6. Electrical Characteristics

Item		Symbol	Condition	Min.	Typ.	Max.	Unit
Supply voltage	Logic	V _{CC}		2.7	2.8	3.3	V
Input Voltage	H level	T _{IH}		0.8*IOVCC		IOVCC	V
	L level	T _{IL}		-0.3		0.2* IOVCC	
Storage temperature		I _{DD}	With internal voltage generation V _{CC} =2.8V; T _{emp} =25°C			TBD	mA

7. Backlight Characteristic

Item	Symbol	Min	Typical	Max	Unit
LED module Forward voltage	V _{LED}	3.0	3.2	3.4	V
LED module current	V _{LED}		60		mA
L/G Surface Luminance	L _S		3500		Cd/m ³
LCM Surface brightness uniform	L _D	80			%

深圳市金点液晶显示电子有限公司

SHENZHENSHI KIND LIQUID CRYSTAL DISPLAYER ELECTRONICS CO., LTD

TEL: 15889732276

8. Module Function Description

引脚序号	引脚名称	作用描述	备注
1-4	DB0-DB3	数据线	
5	GND	接地线	
6	IOVCC	电源供电脚(1.8-3.3V)	
7	/CS	芯片选择, 低电平有效	
8	RS	寄存器选择 0: 寄存器 1: 参数	
9	/WR	写数据信号	
10	/RD	读数据信号	
11	NC	空脚	
12	XR	触摸屏控制线	
13	YU	触摸屏控制线	
14	XL	触摸屏控制线	
15	YD	触摸屏控制线	
16	LED-A	背光正极	
17	LED-K	背光负极	
18	LED-K	背光负极	
19	LED-K	背光负极	
20	LED-K	背光负极	
21	FMARK/NC	悬空	
22	DB4	数据线	
23-30	DB8-DB15	数据线	
31	/RESET	屏复位	
32	VCC	电源供电脚(2.8-3.3V)	
33	IOVCC	电源供电脚(1.8-3.3V)	
34	GND	接地脚	
35-37	DB5-DB7	数据线	

R16 接电阻时, 为 16 位接口, **DB15-DB0** 有用。(默认 16 位)

R8 接电阻时, 为 8 位接口, **DB15-DB8** 有用。

深圳市金点液晶显示电子有限公司

SHENZHENSHI KIND LIQUID CRYSTAL DISPLAYER ELECTRONICS CO. , LTD

TEL: 15889732276

9.Revision history

Version	Revise record	Date
v0.0	Original version	2014-01-18